



PERIOD
HOMES

80 High Street, Ingatestone, CM4 9DW

t. 01277 288000

e. essex@periodhomes.co.uk



Coxtie Green Road
Brentwood CM14 5RP
Offers In Excess Of £325,000

Coxtie Green Road, Brentwood, CM14 5RP

Offered with no onward chain, this delightful two bedroom mid terrace cottage is ideally located just a short drive from Brentwood High Street and within close proximity to Weald Country Park.

The property boasts an open-plan lounge/diner, complete with a feature fireplace. Extended to the rear, the kitchen is fitted with shaker-style wall and base units, offering ample storage and workspace. A separate utility area with garden access leads to a fully tiled contemporary bathroom.

Upstairs, there are two well-proportioned double bedrooms, both featuring built-in wardrobes.

Externally, the private rear garden offers a decked seating area and a small lawn. A rear driveway provides off-road parking, while the front enjoys uninterrupted views across open fields.

Council Tax Band - C



PORCH
LOUNGE/DINING ROOM
19'3 x 11 (5.87m x 3.35m)

KITCHEN
13'4 x 11' (4.06m x 3.35m)

UTILITY

BATHROOM
5'10 x 6'3 (1.78m x 1.91m)

STAIRS LEADING TO

BEDROOM
10'5 x 11' (3.18m x 3.35m)

BEDROOM
8'11 x 11' (2.72m x 3.35m)



Ground Floor
Approx. 40.6 sq. metres (437.1 sq. feet)

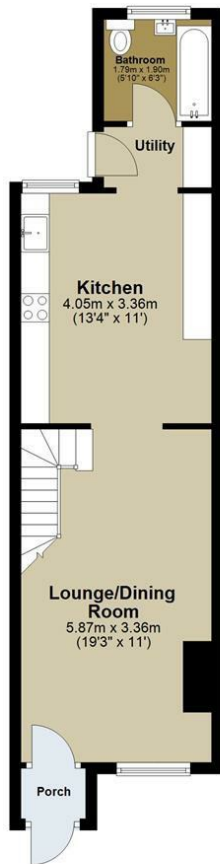

First Floor
Approx. 20.8 sq. metres (223.7 sq. feet)

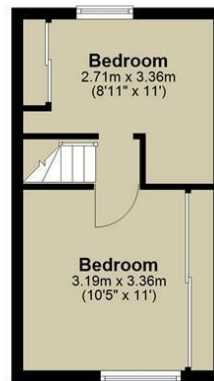

Total area: approx. 61.4 sq. metres (660.9 sq. feet)

All measurements have been taken as a guide to prospective buyers only and are not precise. This plan is for illustrative purposes only and no responsibility for any error, omission or misstatement. The services, systems and appliances shown have not been tested and no guarantee as to their operability or efficiency can be given. Measurements may have been taken from the widest area and may include wardrobe/cupboard space. No guarantee is given to any measurements including total areas. Buyers are advised to take their own measurements. Plan produced using PlanUp.

Coxtie Green Road



PLEASE CALL 01277 288000 TO ARRANGE A VIEWING
www.periodhomes.co.uk

INDEPENDENT ESTATE AGENTS - VALUATIONS WITH NO OBLIGATION - PROFESSIONAL SERVICE

These particulars do not constitute any part of an offer or contract. All measurements are given as a guide, no liability can be accepted for any errors arising therefrom. No responsibility is taken for any other error, omission, or mis-statement in these particulars.

Period Homes, a trading style of Walkers Village and Country Homes Limited do not make or give, whether in these particulars, during negotiations or otherwise, any representation whatsoever in relation to this property.

